

## Parallel : LK7 Series Clamp Type

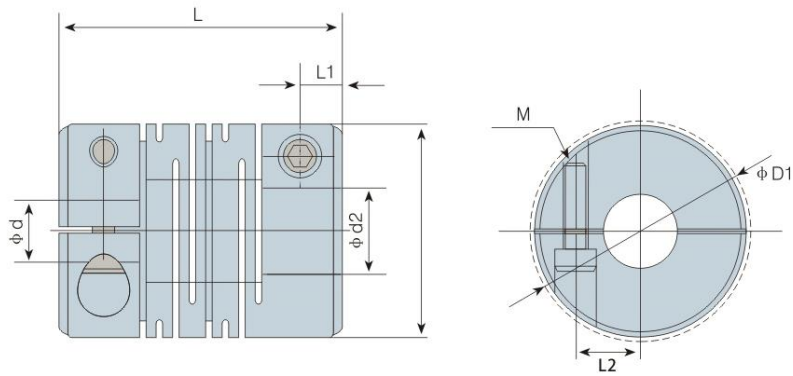

- One-piece metallic spring coupling
- Zero backlash
- Absorption of parallel, angular misalignment and shaft end-play by spring action
- Identical clockwise and anticlockwise rotational characteristics
- Material: Aluminium alloy and stainless steel



Dimensions (mm)

Part No.	d1-d2		ΦD	ΦD1	L	L1	L2	M	Tightening Torque (N.m)
	Min Bore	Max Bore							
LK7-C12	3	5	12	14	18.5	2.5	3.8	M2	0.4-0.5
SLK7-C12	3	5	12	14	18.5	2.5	3.8	M2	0.4-0.5
LK7-C16	4	6.35	16	16.5	23	3.25	5.1	M2.5	1.0-1.1
SLK7-C16	4	6.35	16	16.5	23	3.25	5.1	M2.5	1.0-1.1
LK7-C20	5	9.525	20	20.5	26	3.75	6.8	M2.5	1.0-1.1
SLK7-C20	5	9.525	20	20.5	26	3.75	3.8	M2.5	1.0-1.1
LK7-C25	5	12	25	25	31	4.25	8.5	M3	1.5-1.9
SLK7-C25	5	12	25	25	31	4.25	8.5	M3	1.5-1.9
LK7-C32	6	14	32	32	41	6.0	10.0	M4	3.4-4.1
SLK7-C32	6	14	32	32	41	6.0	10.0	M4	3.4-4.1
LK7-C40	8	18	40	40	56	8.5	13	M5	7.0-8.5
SLK7-C40	8	18	40	40	56	8.5	13	M5	7.0-8.5
LK7-C50	12	19	50	50	71	10.5	16	M6	14-15
SLK7-C50	12	19	50	50	71	10.5	16	M6	14-15
LK7-C63	12	24	63	63	90	13	19	M8	27-30
SLK7-C63	12	24	63	63	90	13	19	M8	27-30

Note :

- 1.For other bore sizes which are not listed above, customized ones are available, please consult us.
- 2.Standard bore tolerance is for the shaft with tolerance h7 or h8, if other tolerance is required, please consult us.

## Specifications

Part No.	Rated Torque (N.m)	Max. Rotational Frequency (rpm)	Moment of Inertia (Kg.m <sup>2</sup> )	Static Torsional Stiffness (N.m/rad)	Errors of Eccentricity (mm)	Errors of Angularity (°)	Errors of Shaft End-play (°)	N.W. (g)
LK7-C12	0.4	10000	9.0x10 <sup>-8</sup>	34	0.1	1.5	± 0.3	4.3
LK7-C16	0.5	9300	3.4x10 <sup>-7</sup>	46	0.1	1.5	± 0.3	9.3
LK7-C20	1	7500	9.4x10 <sup>-7</sup>	118	0.1	1.5	± 0.3	16
LK7-C25	2	6000	2.7x10 <sup>-6</sup>	167	0.15	1.5	± 0.35	28
LK7-C32	4	4600	9.6x10 <sup>-6</sup>	228	0.15	1.5	± 0.35	63
LK7-C40	6.3	3600	3.3x10 <sup>-5</sup>	346	0.2	1.5	± 0.35	143
LK7-C50	11	3000	1.0x10 <sup>-4</sup>	580	0.2	1.5	± 0.35	274
LK7-C63	16	2200	3.2x10 <sup>-4</sup>	843	0.2	1.5	± 0.35	562
SLK7-C12	0.5	10000	2.5x10 <sup>-7</sup>	62	0.1	1.5	± 0.3	12
SLK7-C16	0.6	93000	9.5x10 <sup>-7</sup>	83	0.1	1.5	± 0.3	26
SLK7-C20	1.2	7500	2.6x10 <sup>-6</sup>	246	0.1	1.5	± 0.3	45
SLK7-C25	2.2	6000	7.6x10 <sup>-6</sup>	315	0.15	1.5	± 0.35	79
SLK7-C32	4.4	4600	2.7x10 <sup>-5</sup>	845	0.15	1.5	± 0.35	178
SLK7-C40	7.5	3600	9.6x10 <sup>-5</sup>	990	0.2	1.5	± 0.35	410
SLK7-C50	13	3000	2.8x10 <sup>-4</sup>	1380	0.2	1.5	± 0.35	773
SLK7-C63	19	2200	9.0x10 <sup>-4</sup>	1790	0.2	1.5	± 0.35	1583

**Note:**

1. Moment of inertia and weight are based on the maximum size bores.
2. Dynamic balance is not accounted for in calculating maximum speed.