

Cross Roller Guide Model VR (VR3)

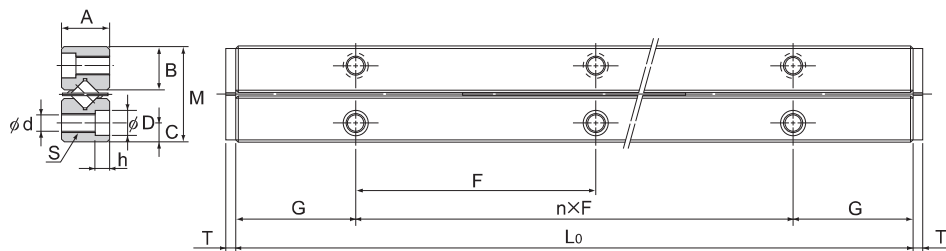

Model No.	Maximum stroke	Main								
		Combined dimensions			Mounting					
		M	A	L ₀	n×F	G	B	C	S	d
VR 3- 50×7Z	28	18	8	50	1×25	12.5	8.3	3.5	M4	3.3
VR 3- 75×10Z	48			75	2×25					
VR 3-100×14Z	58			100	3×25					
VR 3-125×17Z	78			125	4×25					
VR 3-150×21Z	88			150	5×25					
VR 3-175×24Z	108			175	6×25					
VR 3-200×28Z	118			200	7×25					
VR 3-225×31Z	138			225	8×25					
VR 3-250×35Z	148			250	9×25					
VR 3-275×38Z	168			275	10×25					
VR 3-300×42Z	178			300	11×25					

Model number coding

VR3 -75 H × 9Z

Number of rollers or balls
Accuracy symbol
Dedicated rail dimension in mm
(example of indication for a combination of different overall lengths: 100/125)

Combined model number (for Ball Guide: VB)

Note) "One set" in the model No. above indicates a combination of four rails and two cages.

A7-12

THK

Download data by searching for the corresponding model number on the Technical Support site.

<https://tech.thk.com>

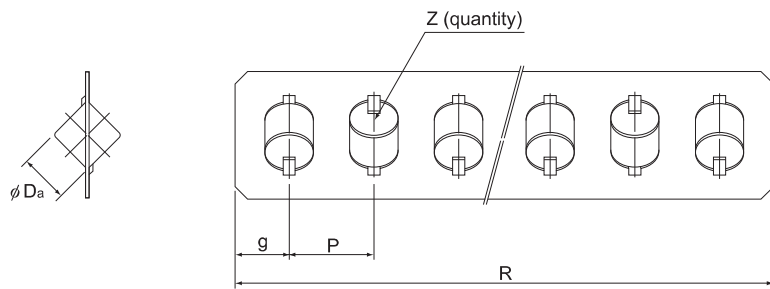

Unit: mm

dimensions								Permissible preload δ μm	Basic load rating (per roller)		Mass (rail) kg/m
dimensions				No. of rollers					C_z kN	C_{oz} kN	
D	h	T	D_s	R	g	P	Z				
6	3.1	2	3	36	3	5	7	-4	0.639	0.611	0.45
				51			10				
				71			14				
				86			17				
				106			21				
				121			24				
				141			28				
				156			31				
				176			35				
				191			38				
211	42										

Note) When desiring a Ball Guide in combination with a ball cage, refer to **A7-26** on Ball Cage Model B and indicate the required number of balls.

(Example) VB3-150H x 20Z

Number of balls

The mass in the table indicates the value per rail/m.

Stainless steel type with high corrosion resistance is also available. (symbol M, e.g., VR3M)