

# SYT TYPE

-SYT3-

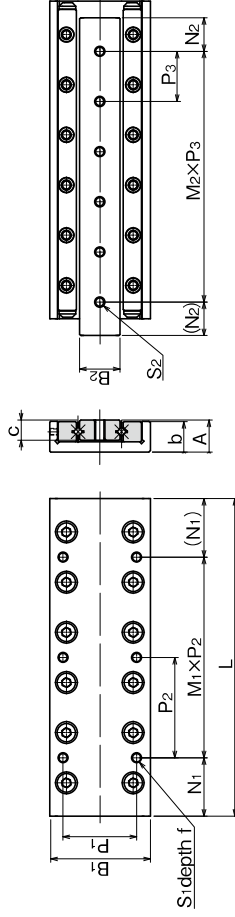

## part number structure

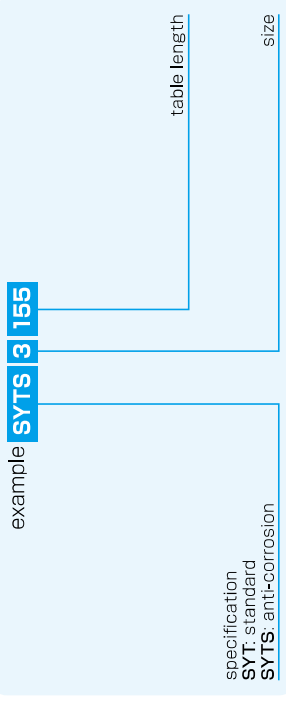

part number	stroke	major dimensions							table-top mounting hole dimensions		
		A mm	B <sub>1</sub> mm	L mm	b mm	B <sub>2</sub> mm	c mm	P <sub>1</sub> mm	S <sub>1</sub> mm	f mm	
SYT 3055	ST 30			55							
3080	45			80							
3105	60			105							
3130	75	16±0.1	40±0.1	130	15.5	16	30	M4	7		
3155	90			155							
3180	105			180							
3205	130			205							

N <sub>1</sub> mm	M <sub>1</sub> × P <sub>2</sub> mm	bed-surface mounting hole dimensions		accuracy ※(deviation)		basic load rating		allowable static moment			mass g	size
		N <sub>2</sub> mm	M <sub>2</sub> × P <sub>3</sub> mm	T μm	S μm	C N	Co N	M <sub>P</sub> N·m	M <sub>V</sub> N·m	M <sub>R</sub> N·m		
7.5	1 × 40	10	1 × 35	2	5	3,490	3,890	19.4	22.2	33.8	225	3055
7.5	1 × 65	15	2 × 25	2	5	5,230	6,490	53.0	58.0	56.4	340	3080
27.5	1 × 50	15	3 × 25	3	5	6,030	7,790	103	95.7	67.7	440	3105
27.5	1 × 75	15	4 × 25	3	5	7,560	10,300	170	160	90.3	560	3130
27.5	2 × 50	15	5 × 25	3	5	9,000	12,900	210	220	112	655	3155
52.5	1 × 75	15	6 × 25	3	5	10,300	15,500	302	314	135	770	3180
27.5	2 × 75	15	7 × 25	3	5	11,000	16,800	355	367	146	880	3205

1N=0.102kgf 1N·m=0.102kgf·m

※ For accuracy (T, S), refer to Figure G-20 (page G-27).

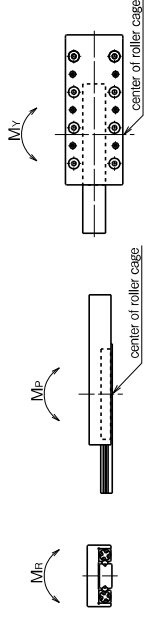

# SYT-D TYPE

-SYT1/SYT2-



## part number structure

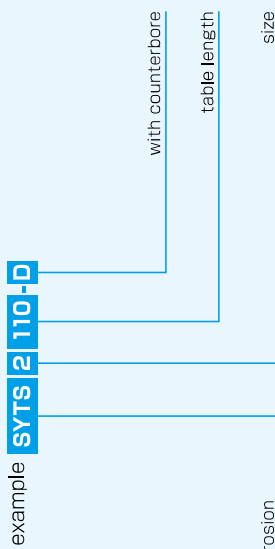

specification  
 SYT: standard  
 SYTS: anti-corrosion

part number	stroke	major dimensions						table-top mounting hole dimensions				
		ST	A	B <sub>1</sub>	L	b	B <sub>2</sub>	c	P <sub>1</sub>	S <sub>1</sub>	f	N <sub>1</sub>
standard	anti-corrosion	mm	mm	mm	mm	mm	mm	mm	mm	mm	mm	mm
SYT1025-D	12				25							3.5
1035-D	18				35							3.5
1045-D	25				45							12.5
1055-D	32	8 <sup>±0.1</sup>	20 <sup>±0.1</sup>		55	6.6	4	14	M2.6	3		12.5
1065-D	40				65	7.5						12.5
1075-D	45				75							22.5
1085-D	50				85							12.5
SYT2035-D	18				35							3.5
2050-D	30				50							3.5
2065-D	40				65							17.5
2080-D	50	12 <sup>±0.1</sup>	30 <sup>±0.1</sup>		80	11.5	6	22	M3	5		17.5
2095-D	60				95							17.5
2110-D	70				110							32.5
2125-D	80				125							17.5

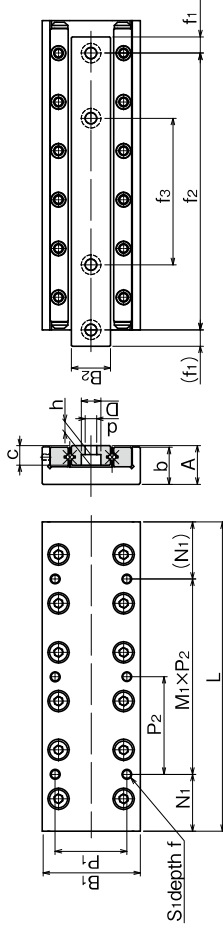

M <sub>1</sub> ×P <sub>2</sub> mm	bed-surface mounting hole dimensions			accuracy ※(deviation)			basic load rating		allowable static moment			mass	size	
	d×D×h mm	f <sub>1</sub> mm	f <sub>2</sub> mm	f <sub>3</sub> mm	T μm	S μm	C N	Co N	M <sub>p</sub> N·m	M <sub>v</sub> N·m	M <sub>R</sub> N·m			g
1×18		3.5	18	—	2	4	464	476	158	1.79	1.47	1.79	22	1025
1×28		5	25	—	2	4	805	952	316	3.08	3.50	3.58	33	1035
1×20		3.5	38	25	2	5	959	1,190	396	6.98	6.40	4.48	42	1045
1×30	2.5×4.1×2.2	3.5	48	29	2	5	1,100	1,420	475	9.53	8.81	5.37	52	1055
2×20		5	55	31	2	5	1,240	1,660	554	12.4	11.6	6.27	63	1065
1×30		5	65	35	2	5	1,510	2,140	712	19.3	18.3	8.06	72	1075
2×30		5	75	40	2	5	1,650	2,380	792	23.4	22.3	8.96	83	1085
1×28		5	25	—	2	4	1,090	1,170	390	7.04	5.78	7.63	79	2035
1×43		7.5	35	—	2	4	1,510	1,750	585	12.1	10.7	11.4	113	2050
1×30		5	55	33	2	5	1,900	2,340	780	19.1	17.1	15.2	150	2065
1×45	3.5×6×3.3	5	70	40	2	5	2,620	3,510	1,170	27.4	29.6	22.8	185	2080
2×30		5	85	45	2	5	2,950	4,100	1,360	37.4	39.9	26.7	215	2095
1×45		7.5	95	50	2	5	3,280	4,680	1,560	61.7	58.1	30.5	255	2110
2×45		7.5	110	55	2	5	3,590	5,270	1,750	76.1	72.1	34.3	295	2125

※For accuracy (T, S), refer to Figure G-20 (page G-27).

1N≒0.102kgf 1N·m≒0.102kgf·m

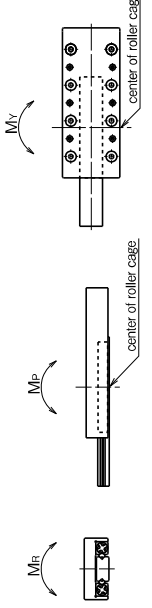

# SYT-D TYPE

-SYT3-



## part number structure

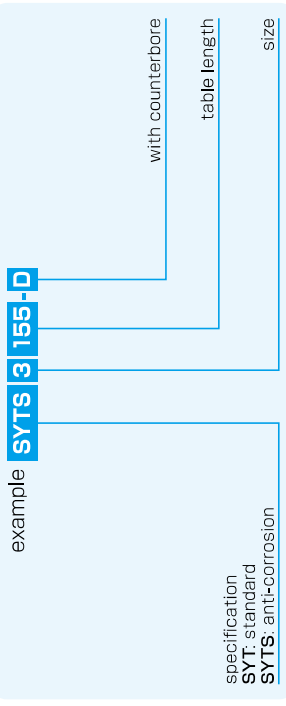

specification  
 SYT: standard  
 SYTS: anti-corrosion

part number	stroke	major dimensions						table-top mounting hole dimensions			
		A	B <sub>1</sub>	L	b	B <sub>2</sub>	c	P <sub>1</sub>	S <sub>1</sub>	f	N <sub>1</sub>
SYT3055-D	ST 30			55							7.5
3080-D	45			80							7.5
3105-D	60			105							27.5
3130-D	75	16 <sup>±0.1</sup>	40 <sup>±0.1</sup>	130	15.5	16	8	M4	7		27.5
3155-D	90			155							27.5
3180-D	105			180							52.5
3205-D	130			205							27.5

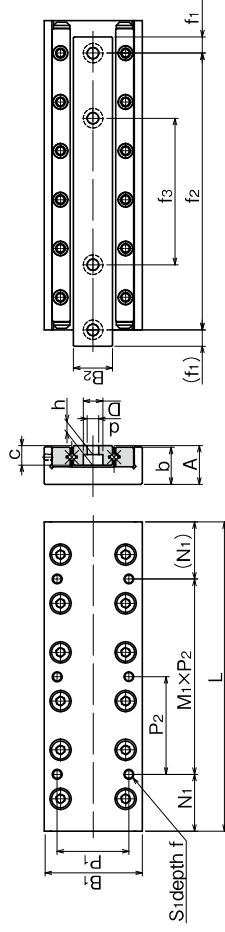

M <sub>1</sub> ×P <sub>2</sub> mm	bed-surface mounting hole dimensions				accuracy ※(deviation)			basic load rating			allowable static moment			mass	size
	d × D × h mm	f <sub>1</sub> mm	f <sub>2</sub> mm	f <sub>3</sub> mm	T μm	S μm	C N	Co N	F N	M <sub>P</sub> N·m	M <sub>V</sub> N·m	M <sub>R</sub> N·m	g		
1 × 40	6	68	43	—	2	5	3,490	3,890	1,290	19.4	22.2	33.8	225	3055	
1 × 65	6	68	43	—	2	5	5,230	6,490	2,160	53.0	58.0	56.4	340	3080	
1 × 50	7.5	90	55	3	5	6,030	7,780	2,590	103	95.7	67.7	440	3105		
1 × 75	7.5	115	65	3	5	7,560	10,300	3,450	170	160	90.3	560	3130		
2 × 50	7.5	140	95	3	5	9,000	12,900	4,320	210	220	112	655	3155		
1 × 75	7.5	165	85	3	5	10,300	15,500	5,180	302	314	135	770	3180		
2 × 75	7.5	190	90	3	5	11,000	16,800	5,610	355	367	146	880	3205		

1N≒0.102kgf 1N·m≒0.102kgf·m

※For accuracy (T, S), refer to Figure G-20 (page G-27).

